

Heavy Duty Type Multicontact

When additional auxiliary contacts are required for DALI, emergency packs or other circuits the Heavy Duty multicontact version is available for loads up to 50 kg. Separate power supplies for the motor, main lamp and auxiliary contacts offer flexibility and dimming facility.

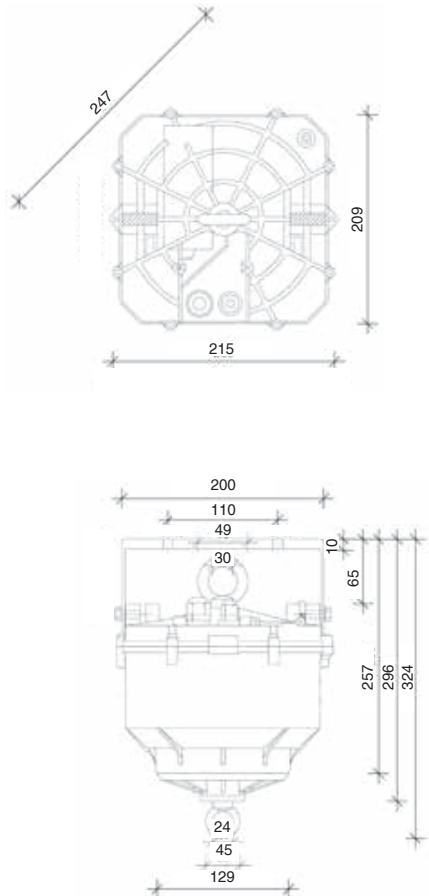

Dimensions:
PSI-20 M, PSI-30 M

Heavy Duty Type Multicontact	PSI-20 M	PSI-30 M	PDI-35 M	PDI-50 M
Lifting capacity	4-20 kg	4-30 kg	8-35 kg	8-50 kg
Lowering distance	20 m	15 m	10 m	10m
Suspension cable	single		dual	
Motor supply and lighting circuit	separate		separate	
Power supply motor	230V AC/50Hz; 120W			
Lighting circuit	16A, 230V AC		16A, 230V AC	
Auxiliary contacts / capacity	4/6A, 230V AC		4/6A, 230V AC	
Protection category / class	IP 54/I		IP 54/I	
Temperature range	-15 °C to + 60 °C		-15 °C to + 60 °C	
Net weight / with packaging	8,7/9,9 kg		8,7/9,9 kg	9,5/10,7 kg